

# FLANGE ADAPTERS

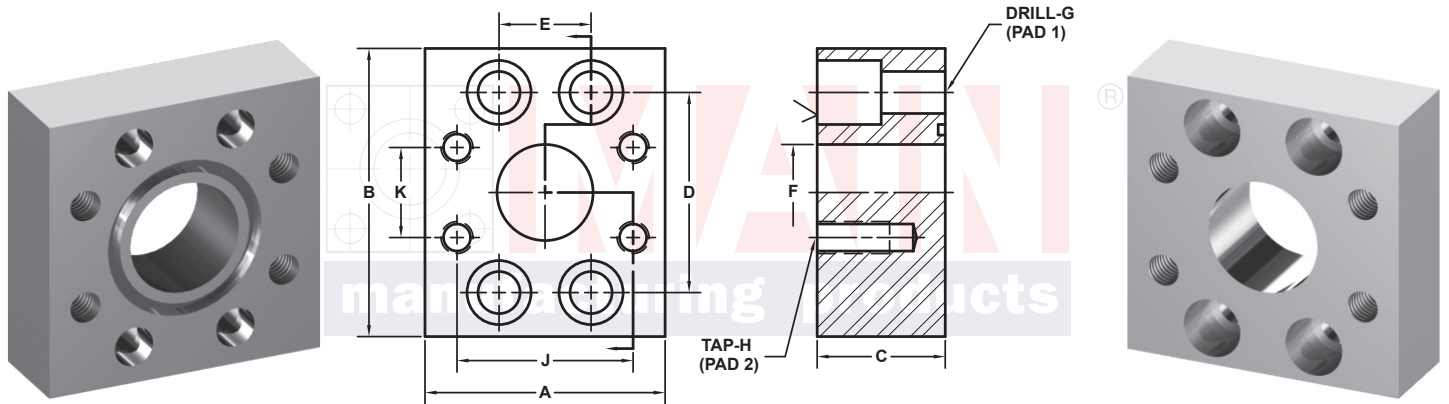

3181 TRI-PARK DR. GRAND BLANC, MI 48439 800-521-7918 810-953-1380 FAX 810-953-1385 INFO@MAINMFG.COM

| SAE BOLT PATTERN |              |                | 61 SERIES <sup>®</sup> TO 62 SERIES |      |      |       |       |      |     |         |       |       |          | MOUNTING KIT <sup>Ⓢ</sup> |        |  |
|------------------|--------------|----------------|-------------------------------------|------|------|-------|-------|------|-----|---------|-------|-------|----------|---------------------------|--------|--|
| PAD 1<br>C61     | PAD 2<br>C62 | PART<br>NUMBER | A                                   | B    | C    | D     | E     | F    | G   | H       | J     | K     | PART NO. | BOLT SIZE                 | O-RING |  |
| 1/2              | 1/2          | 1315-08-08     | 2.25                                | 2.25 | 1.00 | 1.500 | .688  | .50  | .34 | 5/16-18 | 1.594 | .718  | MK 564   | 5/16-18 x 1               | 210    |  |
| 3/4              | 3/4          | 1315-12-12     | 2.81                                | 2.75 | 1.00 | 1.875 | .875  | .75  | .41 | 3/8-16  | 2.000 | .937  | MK 565   | 3/8-16 x 1                | 214    |  |
| 3/4              | 1/2          | 1315-12-08     | 2.25                                | 2.75 | 1.75 | 1.875 | .875  | .50  | .41 | 5/16-18 | 1.594 | .718  | MK 502   | 3/8-16 x 1 3/4            | 214    |  |
| 1                | 1            | 1315-16-16     | 3.19                                | 3.00 | 1.25 | 2.062 | 1.031 | 1.00 | .41 | 7/16-14 | 2.250 | 1.093 | MK 2535  | 3/8-16 x 1 1/4            | 219    |  |
| 1                | 3/4          | 1315-16-12     | 2.81                                | 3.00 | 1.75 | 2.062 | 1.031 | .75  | .41 | 3/8-16  | 2.000 | .937  | MK 503   | 3/8-16 x 1 3/4            | 219    |  |
| 1                | 1/2          | 1315-16-08     | 2.25                                | 3.00 | 1.75 | 2.062 | 1.031 | .50  | .41 | 5/16-18 | 1.594 | .718  | MK 503   | 3/8-16 x 1 3/4            | 219    |  |
| 1 1/4            | 1 1/4        | 1315-20-20     | 3.75                                | 3.25 | 1.25 | 2.312 | 1.188 | 1.25 | .47 | 1/2-13  | 2.625 | 1.250 | MK 567   | 7/16-14 x 1 1/4           | 222    |  |
| 1 1/4            | 1            | 1315-20-16     | 3.19                                | 3.25 | 1.75 | 2.312 | 1.188 | 1.00 | .47 | 7/16-14 | 2.250 | 1.093 | MK 504   | 7/16-14 x 1 3/4           | 222    |  |
| 1 1/4            | 3/4          | 1315-20-12     | 2.81                                | 3.25 | 1.75 | 2.312 | 1.188 | .75  | .47 | 3/8-16  | 2.000 | .937  | MK 504   | 7/16-14 x 1 3/4           | 222    |  |
| 1 1/4            | 1/2          | 1315-20-08     | 2.50                                | 3.25 | 1.50 | 2.312 | 1.188 | .50  | .47 | 5/16-18 | 1.594 | .718  | MK 1527  | 7/16-14 x 1 1/2           | 222    |  |
| 1 1/2            | 1 1/2        | 1315-24-24     | 4.50                                | 3.75 | 1.50 | 2.750 | 1.406 | 1.50 | .53 | 5/8-11  | 3.125 | 1.437 | MK 2536  | 1/2-13 x 1 1/2            | 225    |  |
| 1 1/2            | 1 1/4        | 1315-24-20     | 3.75                                | 3.75 | 1.75 | 2.750 | 1.406 | 1.25 | .53 | 1/2-13  | 2.625 | 1.250 | MK 1547  | 1/2-13 x 1 3/4            | 225    |  |
| 1 1/2            | 1            | 1315-24-16     | 3.19                                | 3.75 | 1.75 | 2.750 | 1.406 | 1.00 | .53 | 7/16-14 | 2.250 | 1.093 | MK 1547  | 1/2-13 x 1 3/4            | 225    |  |
| 1 1/2            | 3/4          | 1315-24-12     | 2.75                                | 3.75 | 1.75 | 2.750 | 1.406 | .75  | .53 | 3/8-16  | 2.000 | .937  | MK 1547  | 1/2-13 x 1 3/4            | 225    |  |
| 1 1/2            | 1/2          | 1315-24-08     | 2.75                                | 3.75 | 1.50 | 2.750 | 1.406 | .50  | .53 | 5/16-18 | 1.594 | .718  | MK 2536  | 1/2-13 x 1 1/2            | 225    |  |

① Order Separately

⑤ **CAUTION:** Flange adapter pressure rating cannot exceed 61 series pad connection.

# FLANGE ADAPTERS

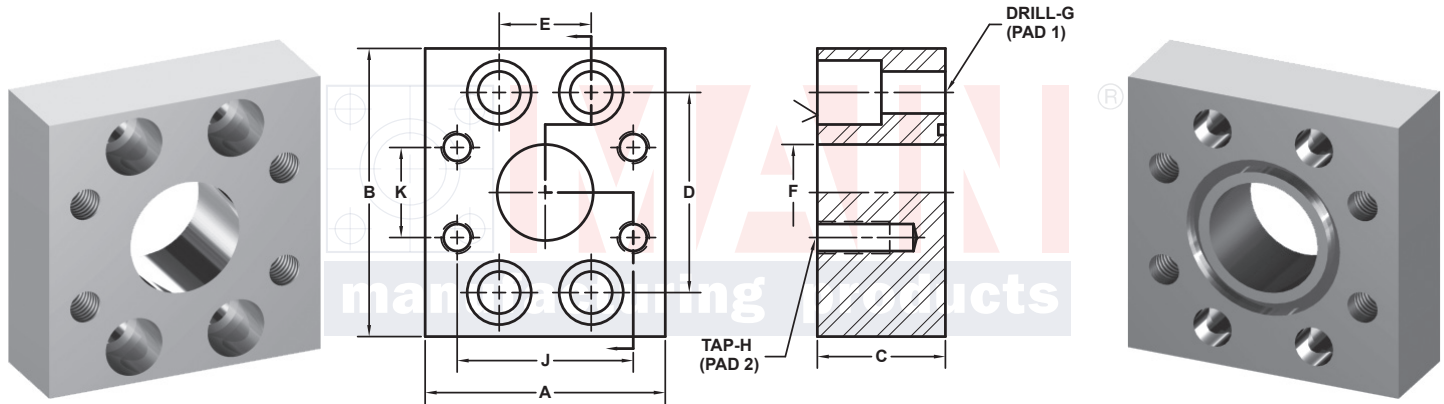

3181 TRI-PARK DR. GRAND BLANC, MI 48439 800-521-7918 810-953-1380 FAX 810-953-1385 INFO@MAINMFG.COM

| SAE BOLT PATTERN          |                           |                |      |      |      |       |       |      |     |         |       |       | 61 SERIES <sup>⑤</sup> TO 62 SERIES |                |        |  |  |
|---------------------------|---------------------------|----------------|------|------|------|-------|-------|------|-----|---------|-------|-------|-------------------------------------|----------------|--------|--|--|
| PAD 1<br>C61              | PAD 2<br>C62              | PART<br>NUMBER | A    | B    | C    | D     | E     | F    | G   | H       | J     | K     | MOUNTING KIT <sup>①</sup>           |                |        |  |  |
|                           |                           |                |      |      |      |       |       |      |     |         |       |       | PART NO.                            | BOLT SIZE      | O-RING |  |  |
| <b>2</b>                  | <b>2</b>                  | 1315-32-32     | 5.25 | 4.00 | 1.75 | 3.062 | 1.688 | 1.94 | .53 | 3/4-10  | 3.812 | 1.750 | MK 582                              | 1/2-13 x 1 3/4 | 228    |  |  |
| <b>2</b>                  | <b>1 1/2</b>              | 1315-32-24     | 4.50 | 4.00 | 1.50 | 3.062 | 1.688 | 1.50 | .53 | 5/8-11  | 3.125 | 1.437 | MK 2537                             | 1/2-13 x 1 1/2 | 228    |  |  |
| <b>2</b>                  | <b>1 1/4</b>              | 1315-32-20     | 3.75 | 4.00 | 2.00 | 3.062 | 1.688 | 1.25 | .53 | 1/2-13  | 2.625 | 1.250 | MK 560                              | 1/2-13 x 2     | 228    |  |  |
| <b>2</b>                  | <b>1</b>                  | 1315-32-16     | 3.25 | 4.00 | 2.00 | 3.062 | 1.688 | 1.00 | .53 | 7/16-14 | 2.250 | 1.093 | MK 560                              | 1/2-13 x 2     | 228    |  |  |
| <b>2</b>                  | <b>3/4</b>                | 1315-32-12     | 3.25 | 4.00 | 1.75 | 3.062 | 1.688 | .75  | .53 | 3/8-16  | 2.000 | .937  | MK 582                              | 1/2-13 x 1 3/4 | 228    |  |  |
| <b>2</b>                  | <b>1/2</b>                | 1315-32-08     | 3.25 | 4.00 | 1.50 | 3.062 | 1.688 | .50  | .53 | 5/16-18 | 1.594 | .718  | MK 2537                             | 1/2-13 x 1 1/2 | 228    |  |  |
|                           |                           |                |      |      |      |       |       |      |     |         |       |       |                                     |                |        |  |  |
| <b>2 1/2</b> <sup>②</sup> | <b>2 1/2</b> <sup>④</sup> | 1315-40-40     | 6.88 | 5.00 | 2.00 | 3.500 | 2.000 | 2.44 | .53 | 7/8-9   | 4.875 | 2.312 | MK 561                              | 1/2-13 x 2     | 232    |  |  |
| <b>2 1/2</b> <sup>②</sup> | <b>2</b>                  | 1315-40-32     | 5.25 | 4.50 | 1.75 | 3.500 | 2.000 | 1.94 | .53 | 3/4-10  | 3.812 | 1.750 | MK 1528                             | 1/2-13 x 1 3/4 | 232    |  |  |
| <b>2 1/2</b> <sup>②</sup> | <b>1 1/2</b>              | 1315-40-24     | 4.50 | 4.50 | 2.25 | 3.500 | 2.000 | 1.50 | .53 | 5/8-11  | 3.125 | 1.437 | MK 1526                             | 1/2-13 x 2 1/4 | 232    |  |  |
| <b>2 1/2</b> <sup>②</sup> | <b>1 1/4</b>              | 1315-40-20     | 4.00 | 4.50 | 2.00 | 3.500 | 2.000 | 1.25 | .53 | 1/2-13  | 2.625 | 1.250 | MK 561                              | 1/2-13 x 2     | 232    |  |  |
| <b>2 1/2</b> <sup>②</sup> | <b>1</b>                  | 1315-40-16     | 4.00 | 4.50 | 2.00 | 3.500 | 2.000 | 1.00 | .53 | 7/16-14 | 2.250 | 1.093 | MK 561                              | 1/2-13 x 2     | 232    |  |  |
| <b>2 1/2</b> <sup>②</sup> | <b>3/4</b>                | 1315-40-12     | 4.00 | 4.50 | 1.75 | 3.500 | 2.000 | .75  | .53 | 3/8-16  | 2.000 | .937  | MK 1528                             | 1/2-13 x 1 3/4 | 232    |  |  |
| <b>2 1/2</b> <sup>②</sup> | <b>1/2</b>                | 1315-40-08     | 4.00 | 4.50 | 1.75 | 3.500 | 2.000 | .50  | .53 | 5/16-18 | 1.594 | .718  | MK 1528                             | 1/2-13 x 1 3/4 | 232    |  |  |
|                           |                           |                |      |      |      |       |       |      |     |         |       |       |                                     |                |        |  |  |
| <b>3</b> <sup>③</sup>     | <b>3</b> <sup>④</sup>     | 1315-48-48     | 8.50 | 6.00 | 2.50 | 4.188 | 2.438 | 2.94 | .66 | 1 1/8-7 | 6.000 | 2.812 | MK 585                              | 5/8-11 x 2 1/2 | 237    |  |  |
| <b>3</b> <sup>③</sup>     | <b>2 1/2</b> <sup>④</sup> | 1315-48-40     | 6.88 | 5.50 | 2.00 | 4.188 | 2.438 | 2.44 | .66 | 7/8-9   | 4.875 | 2.312 | MK 1511                             | 5/8-11 x 2     | 237    |  |  |
| <b>3</b> <sup>③</sup>     | <b>2</b>                  | 1315-48-32     | 5.25 | 5.50 | 2.50 | 4.188 | 2.438 | 1.94 | .66 | 3/4-10  | 3.812 | 1.750 | MK 585                              | 5/8-11 x 2 1/2 | 237    |  |  |
| <b>3</b> <sup>③</sup>     | <b>1 1/2</b>              | 1315-48-24     | 4.50 | 5.50 | 2.25 | 4.188 | 2.438 | 1.50 | .66 | 5/8-11  | 3.125 | 1.437 | MK 2559                             | 5/8-11 x 2 1/4 | 237    |  |  |
| <b>3</b> <sup>③</sup>     | <b>1 1/4</b>              | 1315-48-20     | 4.50 | 5.31 | 2.00 | 4.188 | 2.438 | 1.25 | .66 | 1/2-13  | 2.625 | 1.250 | MK 1511                             | 5/8-11 x 2     | 237    |  |  |
| <b>3</b> <sup>③</sup>     | <b>1</b>                  | 1315-48-16     | 4.50 | 5.31 | 2.00 | 4.188 | 2.438 | 1.00 | .66 | 7/16-14 | 2.250 | 1.093 | MK 1511                             | 5/8-11 x 2     | 237    |  |  |

① Order Separately ② 2500 PSI Max ③ 2000 PSI Max ④ Not included in SAE J518 specifications

⑤ **CAUTION:** Flange adapter pressure rating cannot exceed 61 series pad connection.

# FLANGE ADAPTERS

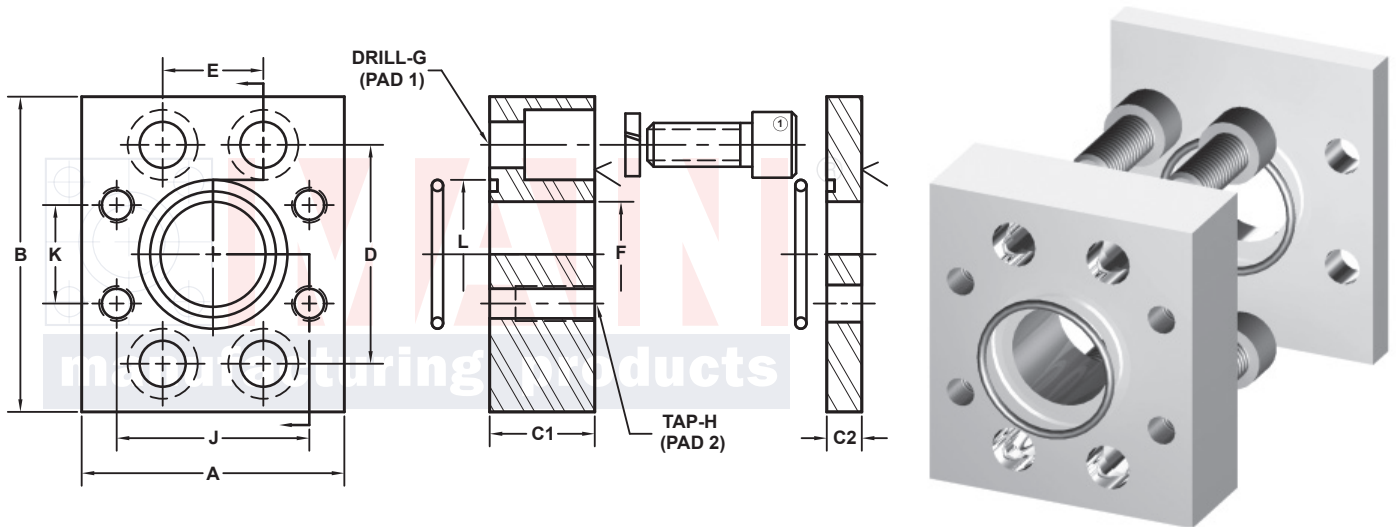

3181 TRI-PARK DR. GRAND BLANC, MI 48439 800-521-7918 810-953-1380 FAX 810-953-1385 INFO@MAINMFG.COM

## SAE BOLT PATTERN

## 61 SERIES<sup>®</sup> TO 62 SERIES

| PAD 1<br>C61 | PAD 2<br>C62             | PART<br>NUMBER | A    | B    | C1   | C2  | D     | E     | F    | G   | H       | J     | K     | L     | MOUNTING KIT <sup>①</sup> |         |
|--------------|--------------------------|----------------|------|------|------|-----|-------|-------|------|-----|---------|-------|-------|-------|---------------------------|---------|
|              |                          |                |      |      |      |     |       |       |      |     |         |       |       |       | BOLT SIZE                 | O-RINGS |
| <b>1/2</b>   | <b>3/4</b>               | 1315-08-12     | 2.81 | 2.25 | 1.00 | .38 | 1.500 | .688  | .50  | .34 | 3/8-16  | 2.000 | .937  | 1.000 | 5/16-18 x 1               | 210     |
| <b>3/4</b>   | <b>1</b>                 | 1315-12-16     | 3.25 | 2.75 | 1.25 | .38 | 1.875 | .875  | .75  | .41 | 7/16-14 | 2.250 | 1.093 | 1.250 | 3/8-16 x 1 1/4            | 214     |
| <b>3/4</b>   | <b>1 1/4</b>             | 1315-12-20     | 3.75 | 2.75 | 1.25 | .50 | 1.875 | .875  | .75  | .41 | 1/2-13  | 2.625 | 1.250 | 1.250 | 3/8-16 x 1 1/4            | 214     |
| <b>1</b>     | <b>1 1/4</b>             | 1315-16-20     | 3.75 | 2.75 | 1.25 | .38 | 2.062 | 1.031 | 1.00 | .41 | 1/2-13  | 2.625 | 1.250 | 1.562 | 3/8-16 x 1 1/4            | 219     |
| <b>1</b>     | <b>1 1/2</b>             | 1315-16-24     | 4.50 | 3.25 | 1.50 | .38 | 2.062 | 1.031 | 1.00 | .41 | 5/8-11  | 3.125 | 1.437 | 1.562 | 3/8-16 x 1 1/2            | 219     |
| <b>1</b>     | <b>2</b>                 | 1315-16-32     | 5.25 | 4.00 | 1.75 | .50 | 2.062 | 1.031 | 1.00 | .41 | 3/4-10  | 3.812 | 1.750 | 1.562 | 3/8-16 x 1 3/4            | 219     |
| <b>1 1/4</b> | <b>1 1/2</b>             | 1315-20-24     | 4.50 | 3.25 | 1.50 | .38 | 2.312 | 1.188 | 1.25 | .47 | 5/8-11  | 3.125 | 1.437 | 1.750 | 7/16-14 x 1 1/2           | 222     |
| <b>1 1/4</b> | <b>2</b>                 | 1315-20-32     | 5.25 | 4.00 | 1.75 | .50 | 2.312 | 1.188 | 1.25 | .47 | 3/4-10  | 3.812 | 1.750 | 1.750 | 7/16-14 x 1 3/4           | 222     |
| <b>1 1/2</b> | <b>2</b>                 | 1315-24-32     | 5.25 | 4.00 | 1.75 | .38 | 2.750 | 1.406 | 1.50 | .53 | 3/4-10  | 3.812 | 1.750 | 2.125 | 1/2-13 x 1 3/4            | 225     |
| <b>2</b>     | <b>2 1/2<sup>④</sup></b> | 1315-32-40     | 6.88 | 5.00 | 2.00 | .50 | 3.062 | 1.688 | 1.94 | .53 | 7/8-9   | 4.875 | 2.312 | 2.500 | 1/2-13 x 2                | 228     |

① Included: (4) Bolts, (4) Lock Washers, (2) O-Rings ④ Not included in SAE J518 specifications

⑤ **CAUTION:** Flange adapter pressure rating cannot exceed 61 series pad connection.